

# ELECTRIC SALAMANDER WITH MOVABLE RADIANT PLATE - SINGLE-PHASE - 4 KW

CODICE  
SE60/OCB

MODELLO  
SE60/OCB

SERIE  
SERIE 600



## GENERAL CHARACTERISTICS

A line of small-sized cooking equipment designed for those who, even in small spaces, do not want to give up great performance. Made of AISI 304 18/10 stainless steel, finely finished with Scotch Brite satin finish, it has rounded edges and large capacity enclosures; it has 600/650 mm depth and modular width of 400/600/700/800/1000 mm; the series is completed by open, armored or refrigerated base supports. The equipment is easily modular to one another until it forms a compact, gap-free whole thanks to a leak-covering profile that provides protection against leakage and thus maximum hygiene. High chimneys, ergonomic knobs mounted on a sloping dashboard for easy visibility, give the range ease of use from the first approach. All models are CE approved.

## TECHNICAL SPECIFICATIONS

■ Constructed of AISI 304 brushed stainless steel. ■ Rubber feet. Incoloy armored heating elements. ■ Ventilation holes at the top for heat and smoke evacuation. ■ Resistances contained in the upper movable top, sliding on guides. ■ SE80/0: 2 self-contained removable grids with athermic handles. ■ Removable chrome-plated steel sauce catchers and grids for cleaning. ■ Possible wall application by means of supports on request.

■ Constructed of brushed stainless steel AISI 304. ■ Rubber feet. Incoloy armored heating elements. ■ Ventilation holes in the upper part for heat and smoke evacuation. Heating elements contained in the movable upper, sliding on guides. ■ Sauce catchers and grids made of removable chrome-plated steel for cleaning ■ Possible wall application by supports on request.

# ELECTRIC SALAMANDER WITH MOVABLE RADIANT PLATE - SINGLE-PHASE - 4 KW

CODICE  
SE60/OCB

MODELLO  
SE60/OCB

SERIE  
SERIE 600

## Technical Information

SPECIFICATION	DATA
MATERIAL	SE60/OCB
SUPPLY	ELECTRICS
DIM. WIDTH	600 mm
DIM. PRODUCTIVITY	450 mm
DIM. HEIGHT	500 mm
STANDARD POWER SUPPLY	220-240V 1N
FREQUENCY	50-60 Hz
ELECTRICAL POWER	4 kW

ELECTRIC SALAMANDER WITH MOVABLE  
RADIANT PLATE - SINGLE-PHASE - 4 KW

CODICE  
SE60/OCB

MODELLO  
SE60/OCB

SERIE  
SERIE 600

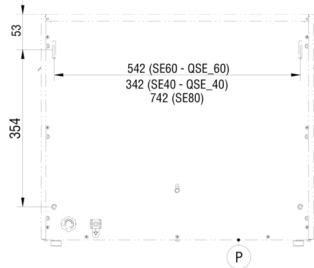
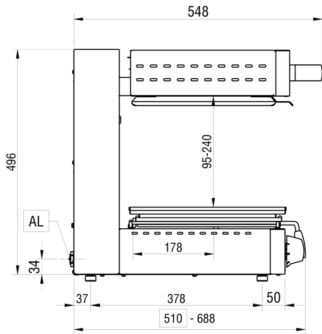
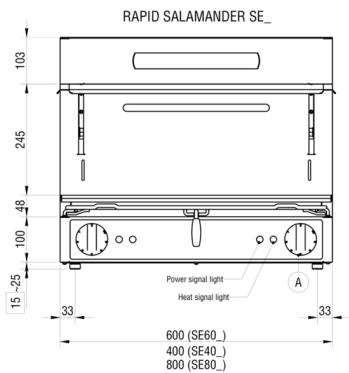

Schema di foratura parete in calcestruzzo per fissaggio staffe  
Diagram for drilling cement walls for the fastening of brackets  
Schema für Betonwandbohrungen zur Befestigung der Wandhalterungen  
Schéma de perçage de la paroi en béton pour fixer les étriers  
Esquema de perforación de la pared de hormigón para fijación soportes

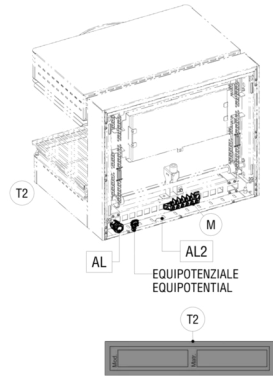
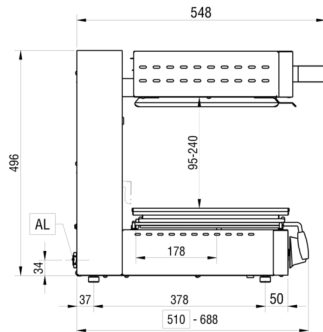
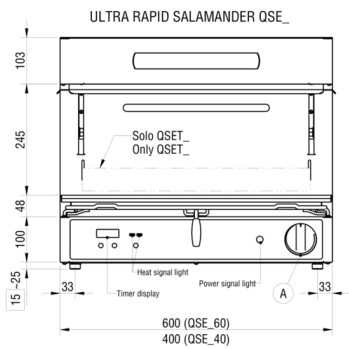

AL Entrata cavo elettrico | Power supply cable inlet | Netzkabeleingang | Entrée cable électrique | Entrada cable eléctrico.  
AL2 Alternativo | Alternative | Alternative | Alternative | Alternativa

Data stampa / Print date: 26.02.20 | Foglio / Sheet: 1/1 | Formato / Format: A3 | Scale / Scale: 0.150 | Modello / Model: SE40\_ | SE60\_ | SE80\_ | QSE\_40 | QSE\_60 | Codice / Code: 5415.693.01

ACCESSORIES

CODE	MODELLO	DESCRIZIONE
9003	9003	STAINLESS STEEL SUPPORTS FOR WALL APPLICATION DEPTH 8 CM (1 PAIR)