

# Gelato —

## GL 1000 P BT

Ice cream



### Technical data

Gross volume	935 lt
Working temperature	-12-30 °C
Motor type	Plug-in
Refrigerant	R290
Refrigeration power	862 W (-25°C / +45°C)
Absorption	1052 W
Voltage/Frequency	230V/1/50Hz
Climate class	5

### Energy data (UE Reg. 2015/1094)

Energy class	C
Daily energy consumption (KWh/24h)	6,71
Annual energy consumption (kWh/annum)	2450
Net Volume	699 lt
Energy efficiency index	50,00
Type	Up-right cabinet: Heavy duty

### Refrigeration details

Refrigeration unit	Tropicalized and easy extractable monoblock unit to guarantee reliability and performance at 43°C. Equipped with low consumption electronic fan motors. Equipped with thermostatic valve.
Refrigerant charge	130 gr
Evaporator	Cataphoresis-treated for high corrosion resistance and installed external to compartment in order to ensure bigger loading capacity
Defrost	Automatic by hot gas for a shorter cycle and less thermal shocks. Smart defrost is activated only in case of real presence of ice in the evaporator, promoting the energy costs reduction and optimal performance
Condensate evaporation	Automatic through anti-corrosion treated compressor coil

## Construction details

Product dimensions WxDxH	810x1060x2120
Packaging dimensions WxDxH	875x1100x2230
Gross weight	208 Kg
Net weight	189 Kg
Structure	Stainless steel AISI 304 monocoque
External/Internal material	Inside and outside in stainless steel AISI 304; internal motor unit compartment, external backside and external bottom in colaminated steel
Insulation thickness	80 mm of HFO polyurethane to guarantee high insulating properties (very low environmental impact: GWP <5 and zero ODP)
Inner corners	Rounded for an easy cleaning
Door	1 Self-closing door with 105° door stop. Right hinged, reversible on-site
Door gasket	Magnetic and removable, designed to improve insulation and to reduce energy consumption
Feet	In AISI 304 stainless steel, height adjustable (90mm-125mm)

## Functions

Control panel	High brightness touch screen display with 6 large digits.
Open door alarm	Visual and acoustic
Functions	Three levels of ventilation intensity management, Led lighting ON/OFF, HACCP alarms through Ice connect (optional)
Connection	As optional: Remote access through serial interface. Via APP (only Android) it is possible to monitor HACCP traceability, appliance operation and parameters. Graphic and as CVS file export of registered data. Email sending of alarms notification

## Accessories

Lighting	Optional
Lock	As standard
No. included accessories	5 - Plastic-coated grid EN 600x800 mm 5 - Pair of anti-rollover runners for grid EN 600x800 mm (Mod. 1000)

## Versions

Versions	Power supply frequency 60Hz
----------	-----------------------------

## Technical drawing

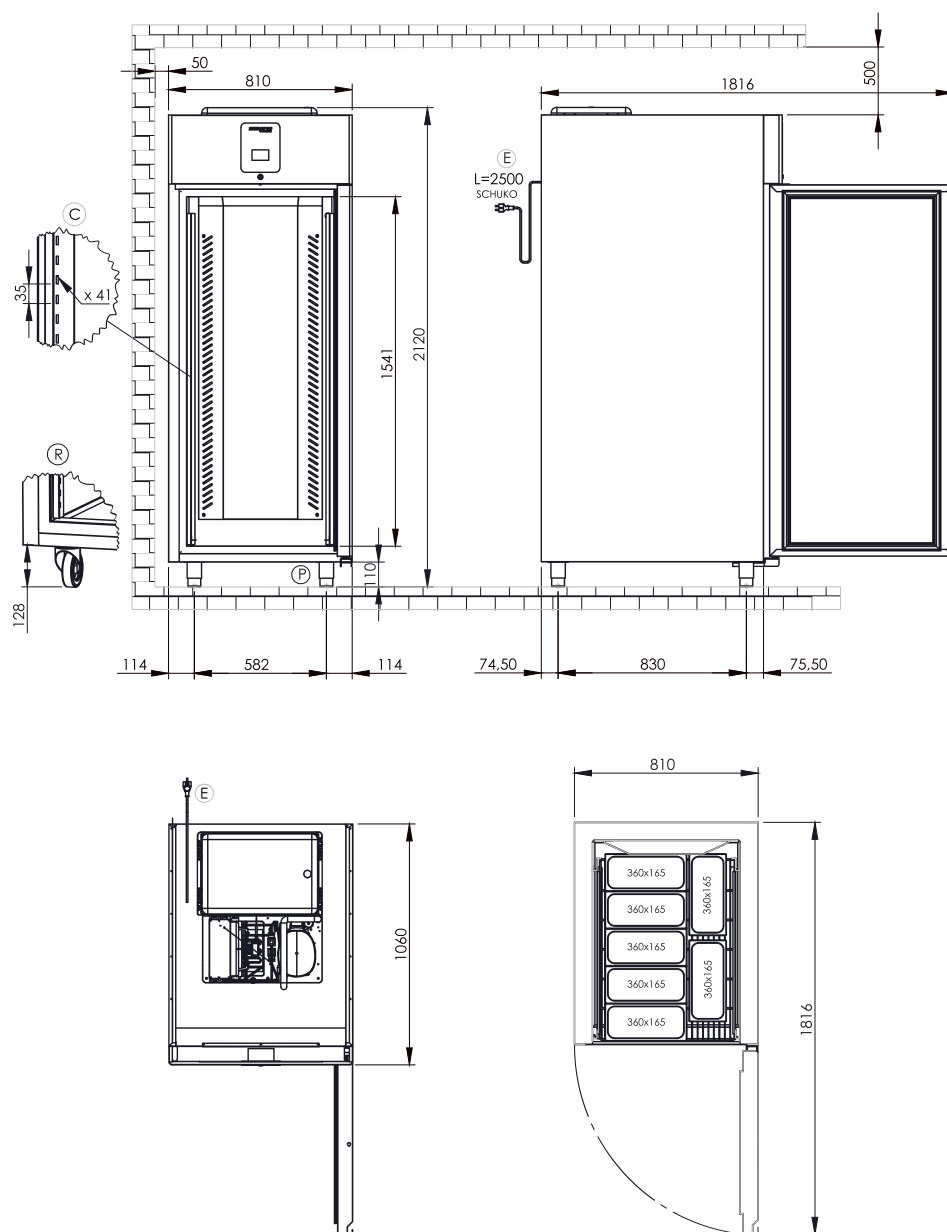

**E** Power supply cable outlet

**C** Racks

**P** Suction line connection

**R** Wheels (optional)